

Configuring the iPhone for Caterease Connect

This document will assist you in configuring your Apple iPhone for use with Caterease Connect. Access to Caterease Connect via mobile devices is provided as a no-charge option and is **NOT** covered under the standard Caterease connect Service Level Agreement.

- 1) Search for **Citrix** in the App Store and Download the App and then Open

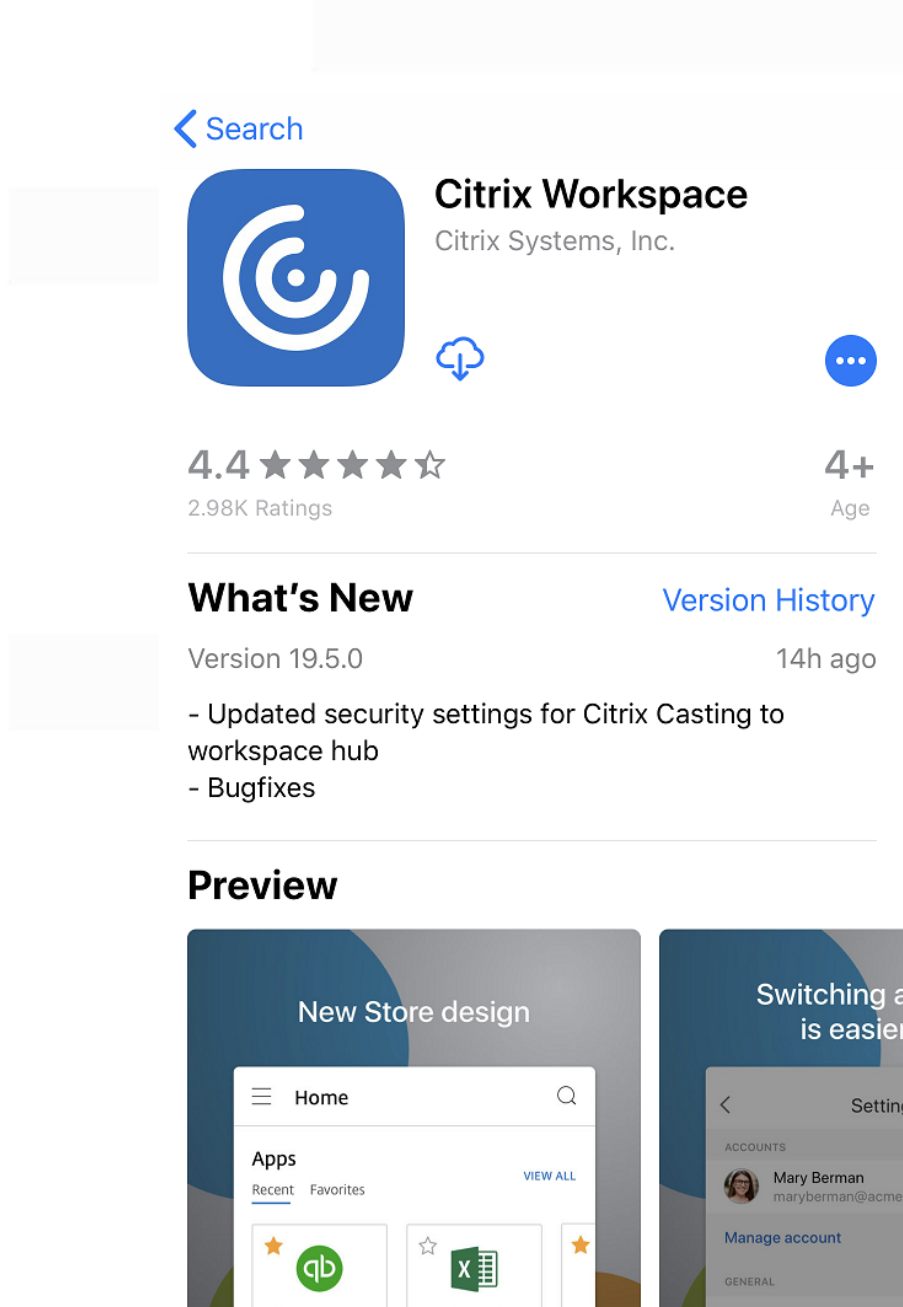

2) Select *Get Started*

 Citrix **Workspace**

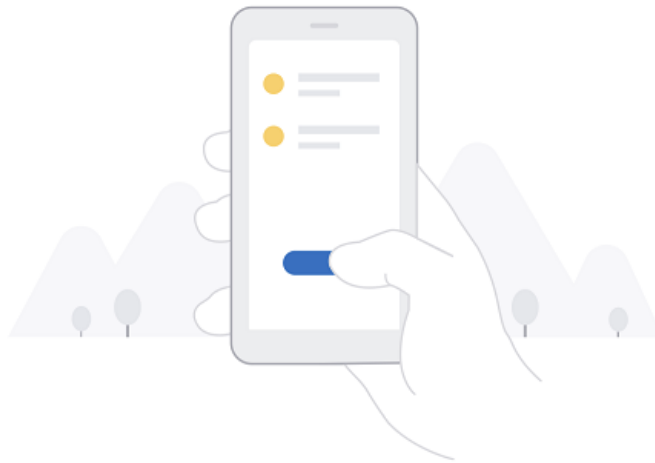

Securely access your favorite apps
and services in one place and access
them anytime on any device

Get Started

Don't have an account? [Try the demo.](#)

3) Tap the button in the upper right-hand corner. Tap the **'Manual Setup'** button.



To get started, enter your company
email address or Store URL

 Email address or Store URL

Use smart card



Continue

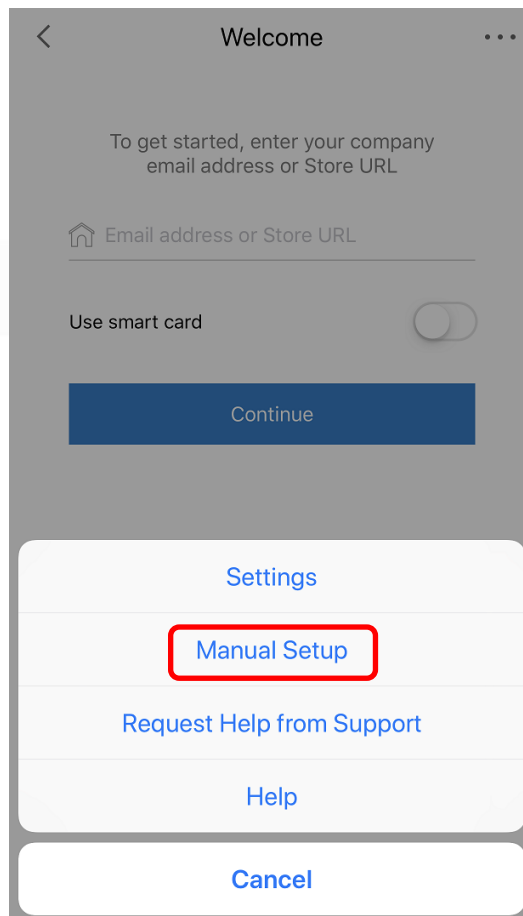

- 4) For the Address enter: <https://login.catereaseconnect.com>
- 5) In the **Description** field type **Caterease**.
- 6) Make sure the box for **Web Interface** is *checked*.
- 7) **Ignore certificate warnings** can remain off.
- 8) Click “**Save**” in the right corner.

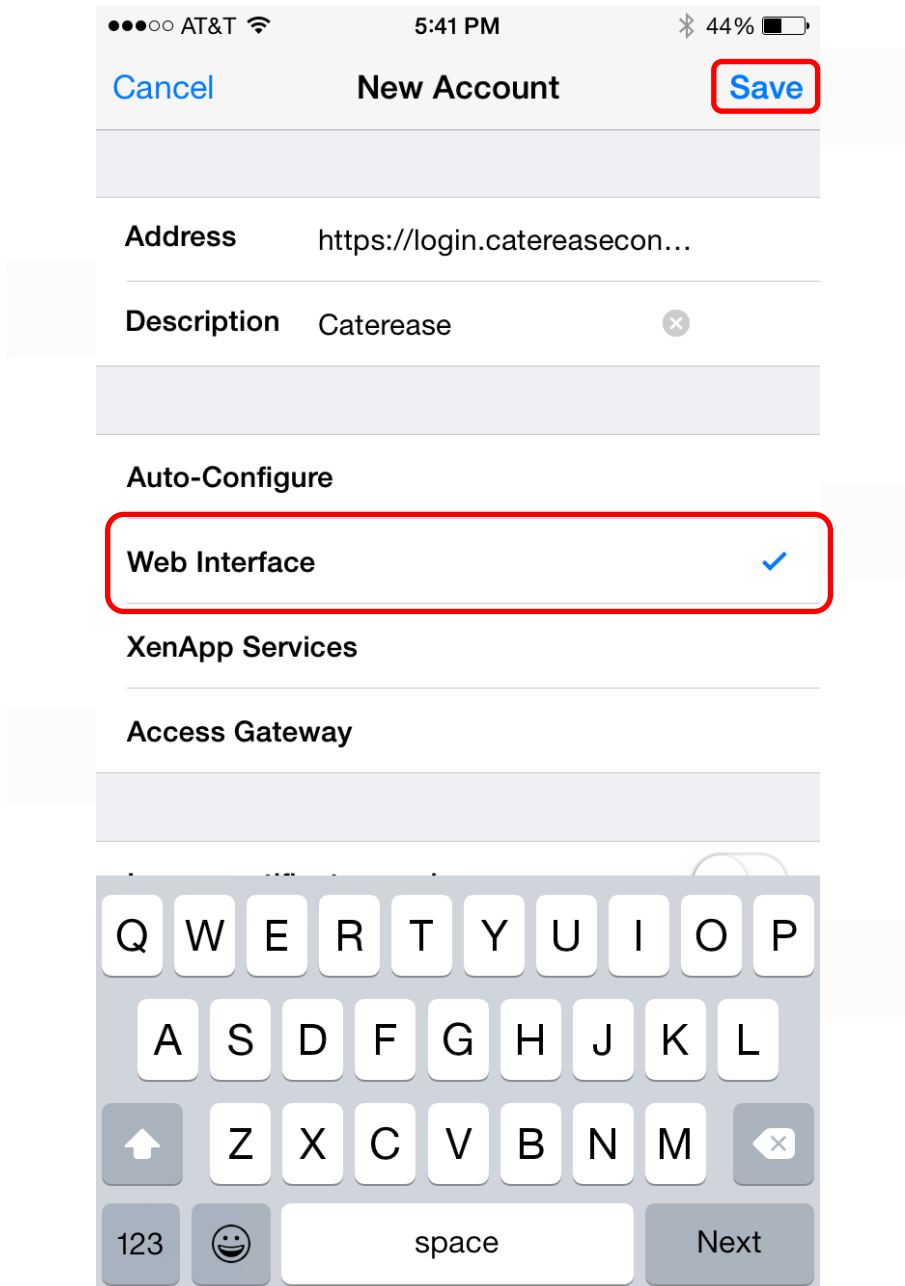
A screenshot of a mobile application interface for creating a new account. The status bar at the top shows 'AT&T', signal strength, time '5:41 PM', and battery level '44%'. The form has a title bar with 'Cancel', 'New Account', and a 'Save' button (highlighted with a red box). The form fields include: 'Address' with the value 'https://login.catereasecon...', 'Description' with the value 'Caterease' (with a clear button), 'Auto-Configure' (checked), 'Web Interface' (checked, highlighted with a red box), 'XenApp Services' (unchecked), and 'Access Gateway' (unchecked). A keyboard is visible at the bottom of the screen.

Cancel New Account Save

Address https://login.catereasecon...

Description Caterease

Auto-Configure

Web Interface

XenApp Services

Access Gateway

At this point the Citrix Receiver App should now be installed and configured for use on your iPhone. You will now be automatically sent to the Caterease Connect login screen.

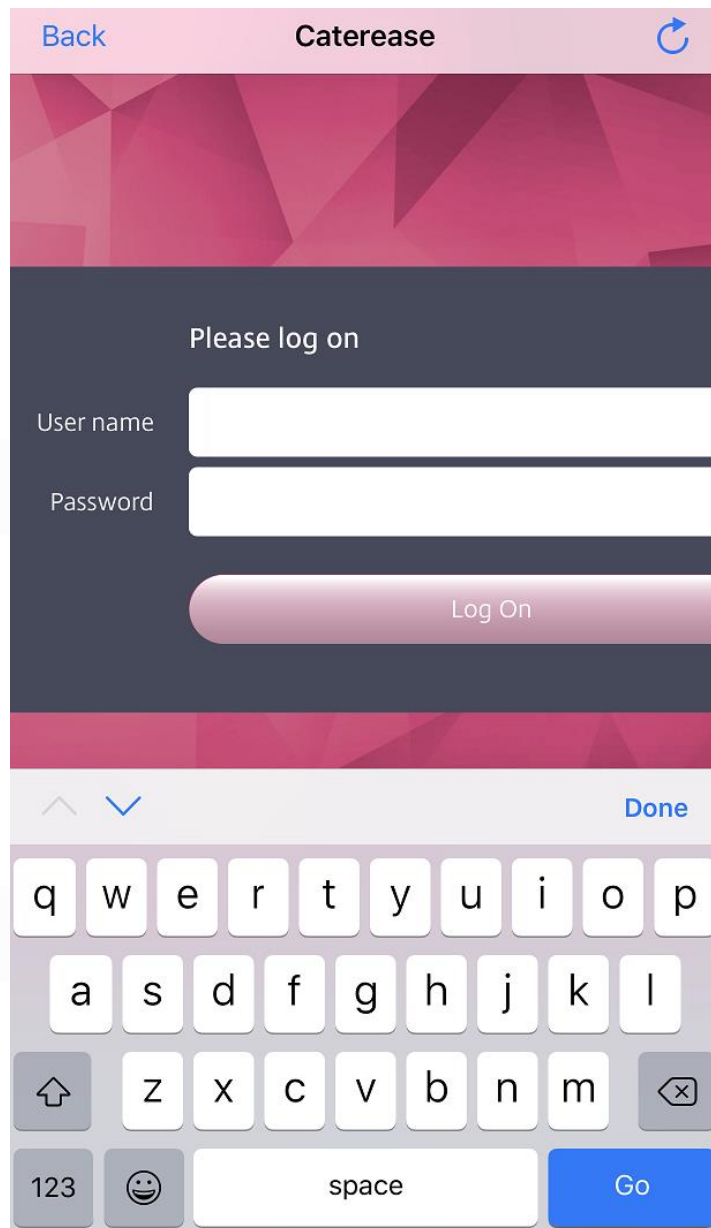
A screenshot of the Caterease login screen on an iPhone. The screen has a pink header bar with a "Back" button on the left, the "Caterease" title in the center, and a refresh icon on the right. Below the header is a dark grey login form with a pink geometric pattern background. The form contains the text "Please log on", two input fields labeled "User name" and "Password", and a pink "Log On" button. At the bottom of the screen is a standard iPhone keyboard with a "Go" button in the bottom right corner.

1. Enter your Caterease Connect username and password then tap the '**Log On**' button.
2. After log on, tap the Caterease icon to start Caterease Connect.

To login again later after closing the App:

1. Open the Citrix Receiver App and tap the **Caterease** account
2. You should then be taken to the Login screen

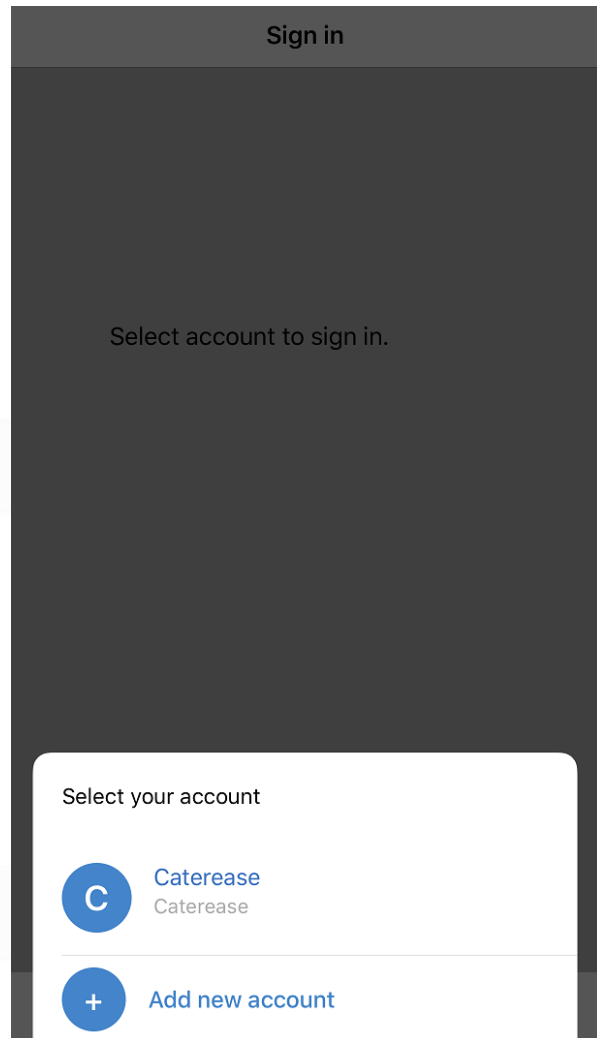

*** Encountering Errors**

If for any reason you encounter an error, please retrace your steps and make sure that you have entered all settings exactly as they appear above – especially checking '**Web Interface**' (Step #6 above).